

# ETHAN ALLEN®

## BREA MODERN DRUM PENDANT ASSEMBLY INSTRUCTIONS

09-3130

### IMPORTANT SAFETY INSTRUCTIONS. READ THESE INSTRUCTIONS COMPLETELY BEFORE STARTING.

We strongly recommend that all direct-wired lighting products be installed by a licensed electrician. Two people may be required for installation. DO NOT EXCEED the rated bulb wattage. Keep flammable materials away from bulb. This light fixture is shipped with all internal wiring intact. Do not open the product or alter the wiring in any manner.

Installation requires an electrical junction box in the ceiling sufficient to support the weight of the light fixture. This fixture weighs 13 lb. (5.9 kg).



**WARNING:** Be certain that the power to the electrical junction box is turned off at the circuit breaker before installation. Turning the power off at a light switch is not sufficient to prevent electrical shock.

CAUTION: Prior to installation, locate ALL INCLUDED PARTS before disposing of packaging materials.

#### TOOLS REQUIRED FOR INSTALLATION:

Screwdriver	Pliers
Electrical Tape	Wire Connectors
Wire Cutters	Adjustable Wrench

Note: Light bulb(s) are not included, except where required by State of California Title 20. See light fixture for bulb specification. Additional wiring supplies may be required.

#### Parts Included (refer to figure):

Part	Qty.	Description	Part	Qty.	Description
A	3	Wire Nuts	J	1	Nipple
B	1	Hot Fixture Wire	K	1	Lock Washer
C	1	Neutral Fixture Wire	L	1	Screw Collar Loop
D	2	Mounting Screws	M	1	Threaded Ring
E	1	Canopy	N	1	Hanging Rod of Link
F	1	Ground Wire	O	1	Hanging Rod (Long)
G	1	Mounting Bracket	P	1	Hanging Rod (Medium)
H	1	Ground Screw	Q	1	Hanging Rod (Short)
I	2	Hex Nut	R	1	Hanging Rod

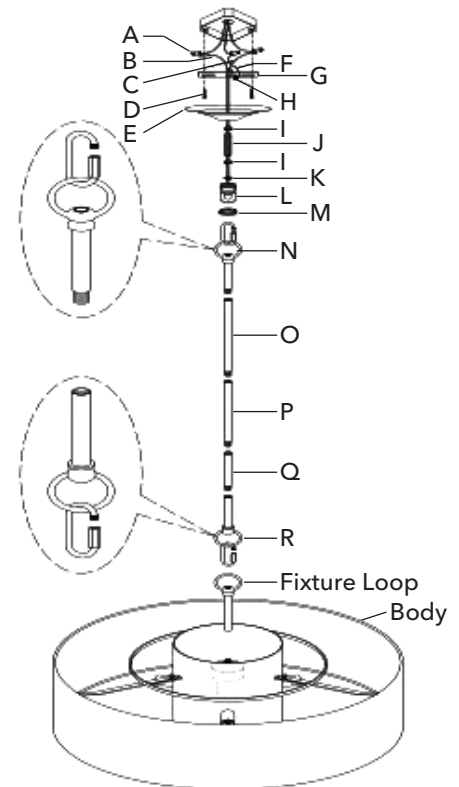

#### Assembly Procedure (refer to figure):

1. SHUT OFF THE MAIN ELECTRICAL SUPPLY AT FUSE BOX/CIRCUIT BREAKER.
2. Remove all parts from carton. Do not throw away any parts.
3. Attach the Fixture Loop to the Body by turning it clockwise until tight.
4. Determine the desired distance between the chandelier and the ceiling and then thread Hanging Rods (R, Q, P, O, and/or N) so that the chandelier will hang at the desired length; do not thread together yet.
5. Guide wiring carefully through Hanging Rods (R, Q, P, O, and/or N). Then, thread each rod together.
6. If needed (depending upon final fixture hanging position from the ceiling), cut off the extra length on the three-wire power cord. When cutting the power cord, be sure to cut it so that at least 6" of cord remains inside the ceiling outlet junction box. Use wire strippers to prepare the ends of the cut wires so that about 1/2" of bare wire is exposed.

## Brea Modern Drum Pendant Assembly Instructions

09-3130

7. Gently pull existing ground, hot, and neutral junction box wires down from the ceiling junction box and allow these to hang.
8. Carefully inspect the fixture wires. The Neutral Fixture Wire (C) is transparent with a white line. The Hot Fixture Wire (B) is transparent without any lines, and the Ground Wire (D) is transparent with a green line.
9. Make proper electrical connections described in steps 9-11. A LICENSED ELECTRICIAN IS RECOMMENDED.
10. Attach the GROUND WIRE (D) from the fixture to the GROUND JUNCTION BOX WIRE from the OUTLET JUNCTION BOX. Fasten each together with a WIRE NUT (A) by twisting the connector in a clockwise direction and wrap the connection with electrical tape. Make sure that no wire strands are exposed. If your CEILING JUNCTION BOX DOES NOT have a GROUND WIRE, be sure to insert the GROUND SCREW (E) into the BACK PLATE (H), marked as "Ground," facing front, and wrap the fixture's bare GROUND WIRE (D) around the GROUND SCREW (E). Tighten the screw to clamp the GROUND WIRE (D) between GROUND SCREW (E) head and BACK PLATE (H). IT IS IMPERATIVE THAT THE JUNCTION BOX IN YOUR HOME BE PROPERLY GROUNDED!
11. Connect the NEUTRAL FIXTURE WIRE (C) to the NEUTRAL JUNCTION BOX WIRE. Fasten each together with a WIRE NUT (A) by twisting the connector in a clockwise direction and wrap the connection with electrical tape. Make sure that no wire strands are exposed.
12. Connect the HOT FIXTURE WIRE (B) to the HOT JUNCTION BOX WIRE. Fasten each together with a WIRE NUT (A) by twisting the connector in a clockwise direction and wrap the connection with electrical tape. Make sure that no wire strands are exposed. DO NOT REVERSE THE HOT AND NEUTRAL CONNECTIONS OR SAFETY WILL BE COMPROMISED.
13. Carefully push wire connections back into ceiling junction box.
14. Attach the Mounting Bracket (G) to the ceiling outlet junction box using the Mounting Screws (D). Tighten screws with a screwdriver until secure.
15. Attach one Hex Nut (I) to the top and the other Hex Nut (I) to the bottom of the Nipple (J). Put the Lock Washer (K) in before attaching the Screw Collar Loop (L) to the bottom end of the Nipple (J).
16. Secure the top of Nipple (J) to the Mounting Bracket (G) with the Hex Nut (I), exposing approximately 2" of its thread. Then secure the Screw Collar Loop (L) to the bottom end of the Nipple (J) with the Hex Nuts (I) and Lock Washer (K).
17. Slide the Canopy (E) and the Threaded Ring (M) over the ceiling outlet junction box and secure it in place by screwing the Threaded Ring (M) onto the Screw Collar Loop (L).
18. Insert one (1) 60W-maximum type A standard medium incandescent light bulb (not included) or one (1) 13W-maximum compact fluorescent bulb (not included) or one (1) 9W-maximum LED bulb (not included) into the center socket. Do not exceed the specified wattage.
19. Insert three (3) 60W-maximum type B candelabra-base incandescent light bulbs (not included) or three (3) 13W-maximum compact fluorescent bulbs (not included) or three (3) 9W-maximum LED bulbs (not included) into each socket. Do not exceed the specified wattage. *To avoid any shadows on the shade and to achieve the best overall look, we recommend (3) 60W-maximum type G (G16-1/2) candelabra base-incandescent frosted lightbulbs.*
18. Restore power to ceiling outlet junction box and test the fixture.

### Care and Cleaning

1. Wipe with a soft dry cloth.
2. AVOID cleaners, scouring pads, etc.

After troubleshooting, if the light fixture still does not work, contact your local Ethan Allen Design Center.

SAVE THESE INSTRUCTIONS