

ETHAN ALLEN®

093129 KUSAMA ABSTRACT CHANDELIER

ASSEMBLY INSTRUCTIONS

IMPORTANT SAFETY INSTRUCTIONS

READ THESE INSTRUCTIONS COMPLETELY BEFORE STARTING.

We strongly recommend that all direct-wired lighting products be installed by a licensed electrician. Two people may be required for installation. DO NOT EXCEED the rated bulb wattage. Keep flammable materials away from bulb. This light fixture is shipped with all internal wiring intact. Do not open the product or alter the wiring in any manner.

Installation requires an electrical junction box in the ceiling sufficient to support the weight of the light fixture.

This fixture weighs: 17.23lb. 7.83kg.



WARNING: Be certain that the power to the electrical junction box is turned off at the circuit breaker before installation. Turning the power off at a light switch is not sufficient to prevent electrical shock. *Remove the silica gel pack from the socket before plugging the lamp in.*

CAUTION: Prior to installation, locate ALL INCLUDED PARTS before disposing of packaging materials.

Tools Required For Installation:

Screwdrivers	Pliers
Electrical Tape	Wire Connectors
Wire Cutters	Adjustable Wrench

Note: Lightbulb(s) are not included, except where required by State of California Title 20. See light fixture for bulb specification. Additional wiring supplies may be required.

Parts Include (Refer to figure) :

Part	Qty.	Description
A	3	Wire nuts
B	1	Hot Fixture Wire
C	1	Neutral Fixture Wire
D	1	Ground Wire
E	1	Ground Screw
F	2	Mounting Screws
G	1	Back Plate
H	4	Canopy Screws
I	1	Canopy
J	4	Cable Gripper
K	1	Set Screw
L	4	Closable Link
M	4	Steel Cables
N	16	Sockets

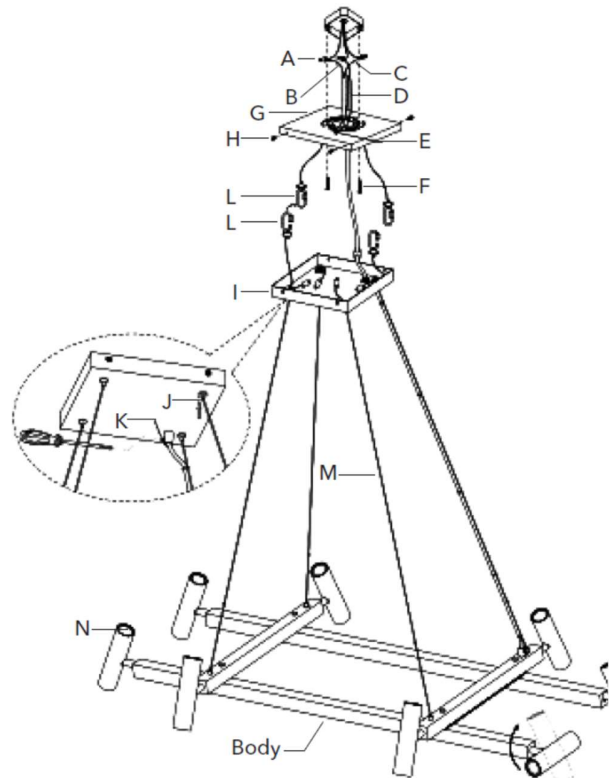

093129 KUSAMA ABSTRACT CHANDELIER

Assembly instructions continued

Installation Procedure (See Figure):

1. SHUT OFF THE MAIN ELECTRICAL SUPPLY AT FUSE BOX/CIRCUIT BREAKER.
2. Carefully unpack all fixture parts and hardware from carton. Do not throw away any parts.
3. Secure the Back plate (G) onto the Ceiling Outlet Junction Box, using Mounting Screws (F) to tighten the back plate. Tighten screws with a Screwdriver until secure.
4. Adjust the Steel Cable length by pushing the Cable Gripper (J) on the canopy and pulling the wire as desired. Make sure keeping 4 Steel Cable same length and whole Steel Cable is level.
5. Loosen the Set Screw (K) located on the collar of the Canopy (I) using a flat head screwdriver by turning counterclockwise. Pull the wire upwards or downwards to adjust the fixture for a new desired suspension length and then tighten the Set Screw (K) using the flat head screwdriver. Do not over tighten the screw – just make sure that the wire will not slip downwards and reliably secured in place.
6. Gently pull existing Ground, Hot, and Neutral Junction Box Wires down from the Ceiling Junction Box and allow them to hang.
7. With the help of another people to hold the weight of the light fixture, unscrew each closable link screw cap from the Closable Links (L) of Canopy (I), and attach each Closable Link (L) of the Canopy (I) onto each Closable Link (L) from the Back Plate (G). Tighten each closable link screw cap. Now the lighting fixture is supported by the steel wire.
8. Carefully inspect the chandelier's fixture wires. The Neutral Fixture Wire (C) is transparent with white line. The Hot Fixture Wire (B) is transparent without line, and the Ground Wire (D) is transparent with green line.
9. Make proper electrical connections described in steps 9–11. A LICENSED ELECTRICIAN IS RECOMMENDED.
10. Attach the Ground Wire (D) from the fixture to the Ground Junction Box Wire; it usually has green insulation around it or is bare wire. Fasten them together with a Wire Connector (A) and wrap the connection with electrical tape. Make sure that no wire strands are exposed. If your Ceiling Outlet Junction Box does not have a Ground Junction Box Wire, insert the Ground Screw (E) into the Back Plate (G) where it's marked "Ground", and wrap the fixture's bare ground wire around the Ground Screw (E). Tighten the screw to clamp the Ground Junction Box Wire between the Ground Screw (E) head and the Back Plate (G). It is imperative that the Ceiling Junction Box in your home be properly grounded.
11. Connect the Neutral Fixture Wire (C) to the Neutral Junction Box Wire; it usually has white insulation around it. Fasten them together with a plastic Wire Connector (A) and wrap the connection with electrical tape. Make sure that no wire strands are exposed.
12. Connect the Hot Fixture Wire (B) to Hot Junction Box Wire; it usually has black insulation around it. Fasten them together with a plastic Wire Connector (A) and wrap the connection with electrical tape. Make sure that no wire strands are exposed. Do not reverse the hot and neutral connections or safety will be compromised.
13. Gently tuck the wire connections neatly into the Ceiling Outlet Junction Box.
14. Place the Canopy (I) over the Ceiling Outlet Junction Box, aligning the screws on the back plate (G) with the mounting holes on the canopy (I). Lock it securely with the Canopy Screws (H).
15. Adjust the direction of each socket according to the demand.

093129 KUSAMA ABSTRACT CHANDELIER

Assembly instructions continued

16. Insert SIXTEEN (16) 25-Watt MAXIMUM Type T standard medium base incandescent light bulb (not included) or SIXTEEN (16) MAXIMUM 6-Watt compact fluorescent light bulb (not included) or SIXTEEN (16) MAXIMUM 4-watt LED light bulb (included). DO NOT EXCEED SPECIFIED WATTAGE.
17. For your convenience SIXTEEN (16) 4-Watt LED light bulb are included.

CARE AND CLEANING:

To clean, wipe the light fixture ONLY with a soft dry cloth. In the event that the light fixture does not work, contact your local Ethan Allen Design Center.